

Flat 6, Woodland Court Hart Hill Drive, Luton, LU2 0AX
£950 PCM

- EXCLUSIVE TO PR PROPERTY
- 2-minute walk to Luton station
- Ideal for singles or couples

- One-bedroom apartment
- On-site parking
- Available late May 2026

- Woodland Court, Hart Hill Drive, Luton
- Close to local transport links

**** Exclusive to PR Property **** A smart one-bedroom apartment in Woodland Court on Hart Hill Drive, Luton, offered to rent Late May 2026. Set in the town center, this flat sits about a two-minute walk from Luton station and benefits from on-site parking and close local transport links, making it a practical option for singles, couples and commuters. The accommodation provides a compact, low-maintenance base in a well-connected location

ENTRANCE HALL

LIVING ROOM 15'00 X 13'1 (4.57M X 3.99M)

KITCHEN 11'1 X 5'10 (3.38M X 1.78M)

BEDROOM 11'8 X 8'10 (3.56M X 2.69M)

BATHROOM

First Floor
Approx. 39.6 sq. metres (426.0 sq. feet)

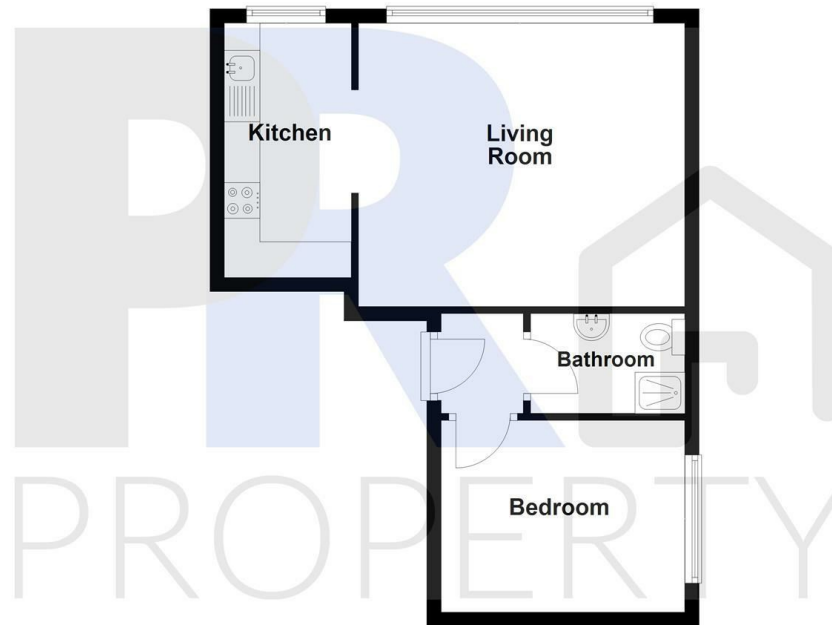

Total area: approx. 39.6 sq. metres (426.0 sq. feet)
6 Woodland Court, Luton

| Energy Efficiency Rating | | Current | Potential |
|---------------------------------------------|---|-------------------------|-----------|
| Very energy efficient - lower running costs | | | |
| (92 plus) | A | | |
| (81-91) | B | | |
| (69-80) | C | | 78 |
| (55-68) | D | | |
| (39-54) | E | 50 | |
| (21-38) | F | | |
| (1-20) | G | | |
| Not energy efficient - higher running costs | | | |
| England & Wales | | EU Directive 2002/91/EC | |